

THE INFORMATION CONTAINED HEREIN IS PROPRIETARY TO CARLISLE, INC. AND SHALL IN NO WAY BE REPRODUCED OR DISCLOSED IN WHOLE OR IN PART OR USED FOR ANY DESIGN OR MANUFACTURE EXCEPT WHEN SUCH USER POSSESSES DIRECT, WRITTEN AUTHORIZATION FROM CARLISLE, INC.

REVISION HISTORY			
REV	DESCRIPTION	DATE	APPD
NC	NEW RELEASE PER E.O. 20139	03-01-10	LBO
A	REVISED PER E.O. 23893	10/11/16	<i>[Signature]</i>

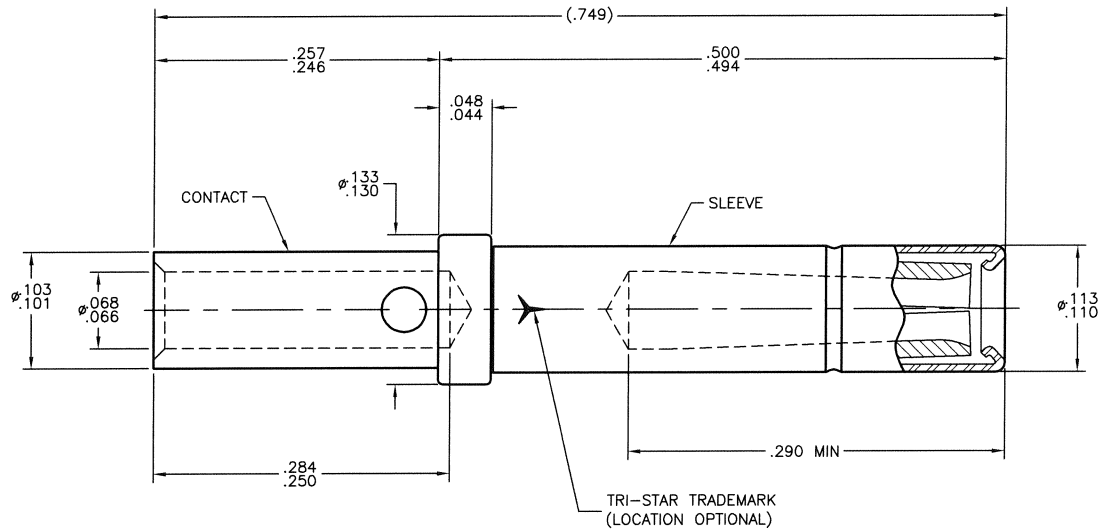

SALES DRAWING

5. **CRIMP TOOL DATA:**
 BASIC CRIMP TOOL - M22520/1-01.
 POSITIONER - M22520/1-02 BLUE.

4. ENGAGEMENT AND SEPARATION FORCES AS39029.

③ **FINISH:** CONTACT - GOLD PLATE PER MIL-DTL-45204 OVER NICKEL PLATE PER AMS-QQ-N-290

② **MATERIAL:**
 CONTACT - SUITABLE COPPER ALLOY PER AS39029.
 SLEEVE - STAINLESS STEEL, PASSIVATED.

1. www.carlisleit.com

NOTES: (UNLESS OTHERWISE SPECIFIED)

DIMENSIONING AND TOLERANCING SHALL BE INTERPRETED PER ASME Y14.5M-1994. DIMENSIONS ARE IN INCHES/MILLIMETERS ±TOLERANCES UNLESS OTHERWISE NOTED			
.X	.XX	.XXX	ANGLE
±.1	±.01	±.005	±.30'
THIRD ANGLE PROJECTION			
MATERIAL:	FINISH:	TREATMENT:	REF:
②	③	--	--

NAME	DATE
DRAWN: F. RODRIGUEZ	02-22-10
CHECKED:	
APPROVED:	LBO 03-01-10

CARLISLE
INTERCONNECT TECHNOLOGIES

TRI-STAR
ELECTRONICS INTERNATIONAL

2201 ROSECRANS AVENUE, EL SEGUNDO, CA 90245

CONTACT, ELECTRICAL CONNECTOR
SOCKET, CRIMP REMOVABLE,
SIZE 16-16

SIZE	CAGE CODE	CARLISLE NUMBER	REV.
A	55104	D10-1616-089	A

SCALE 6.25X- DO NOT SCALE DWG SHEET 1 OF 1